



CRANE DATA	
Crane Type	LIEBHERR-LTM250-6.1
Outrigger Setting	8.85M-X-8.3M
Counterweight Setting	35-TONNES
OS/AL/SL Code	0013
Main Boom Configuration	46-46-46-46-92
Main Boom Length	46.7-METRES
fly Configuration	N/A
Job Length	N/A
Winch Line Pull	10.5-TONNES
Parts Of Use	3-PARTS
Resulting Hook Capacity	31.5-TONNES
LIFT SPECIFICATION	
Load Description	COAL-GRINDING-FILTER
Load Weight	16-TONNES
Tackle Weight	1,292-KG'S
Hook Weight	840-KG'S
Total Lift Weight	18.2-TONNES
Maximum Lift Radius	15.5-METRES
Chart Capacity	27.7-TONNES
Crane Utilization	65.7%
Maximum Wind Speed	11.1-M/S
Maximum Outrigger Load	55-TONNES
Outrigger Pad Size	2M-X-3M-5M <sup>2</sup>
Max Ground Pressure	11-TONNES-M <sup>2</sup>
All Equipment is supplied in accordance with MAX Cranes & Equipment Hire Terms & Conditions & Relevant Australian Standards	
This drawing and the technical information it conveys may not be copied, used or disclosed, without the permission of Max Cranes & Equipment Hire (NSW) Pty Ltd	

**MAX**  
**PRECISION LIFTING**  
**TRANSPORE**

Head Office: 0818113195 Fax: (08)88519377  
 Crane Supervisor: Tel: 0810113144 Email: max@maxcranes.com.au  
 Internet: www.maxcranes.com.au

Client	PPRCMT		
Site	MYRSTAR-PORT-PIRIE		
Project	MYRSTAR-TRANSFORMATION-PROJECT		
Title	COAL-GRINDING-FABRIC-FILTER BAGHOUSE-LIFT-16-TONNE		
A4 Scale	DNS	A3 Scale	DNS
Date	19/08/2016	Drawn	M.RUDKIN
Sheet No.	SHT of SHT2	Checked	M.KUHN
Drawing No	MYRSTAR0016	Rev	A

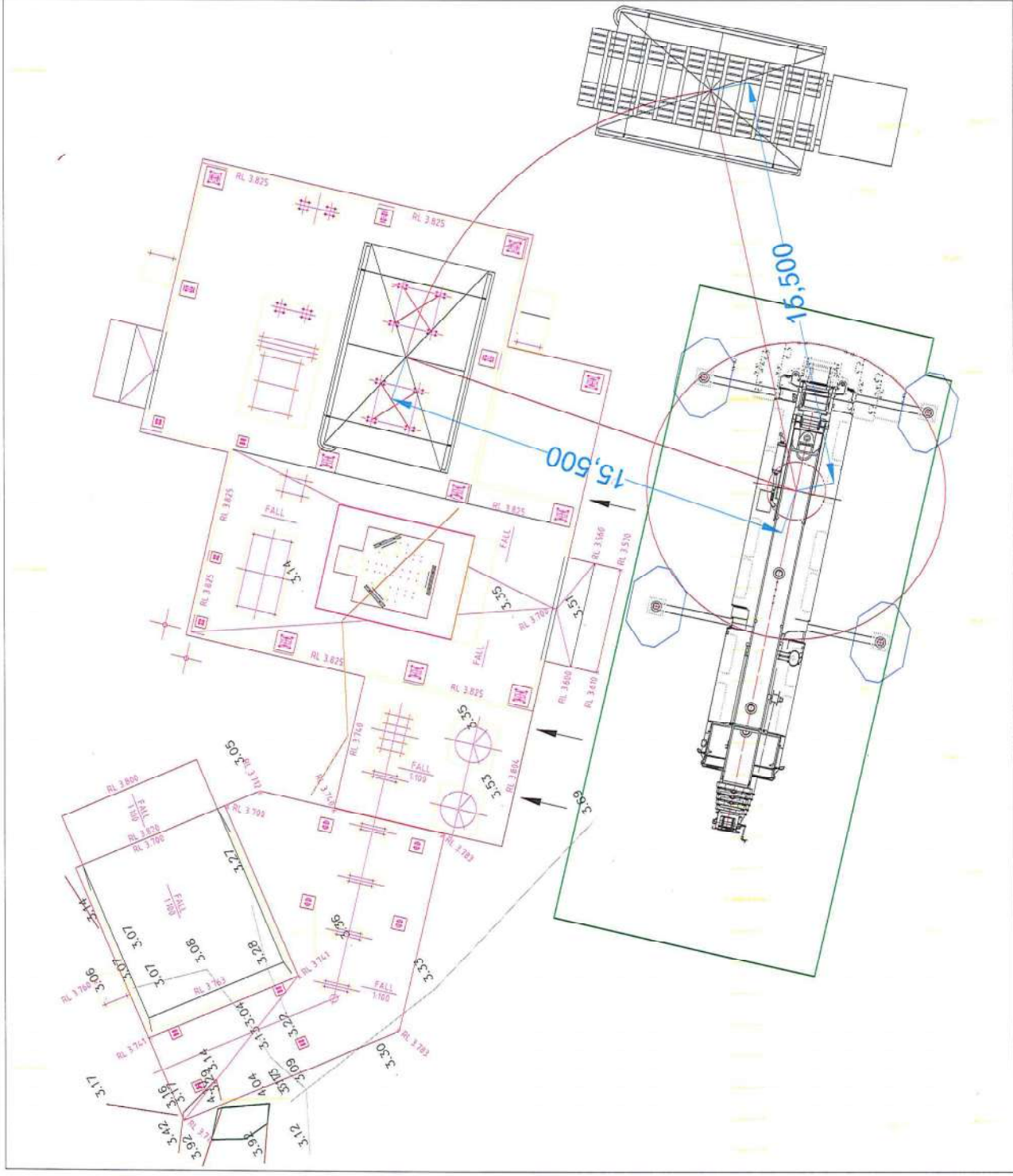

# Tackle Sketch and Side View of 16t Coal Filter Lift - Baghouse

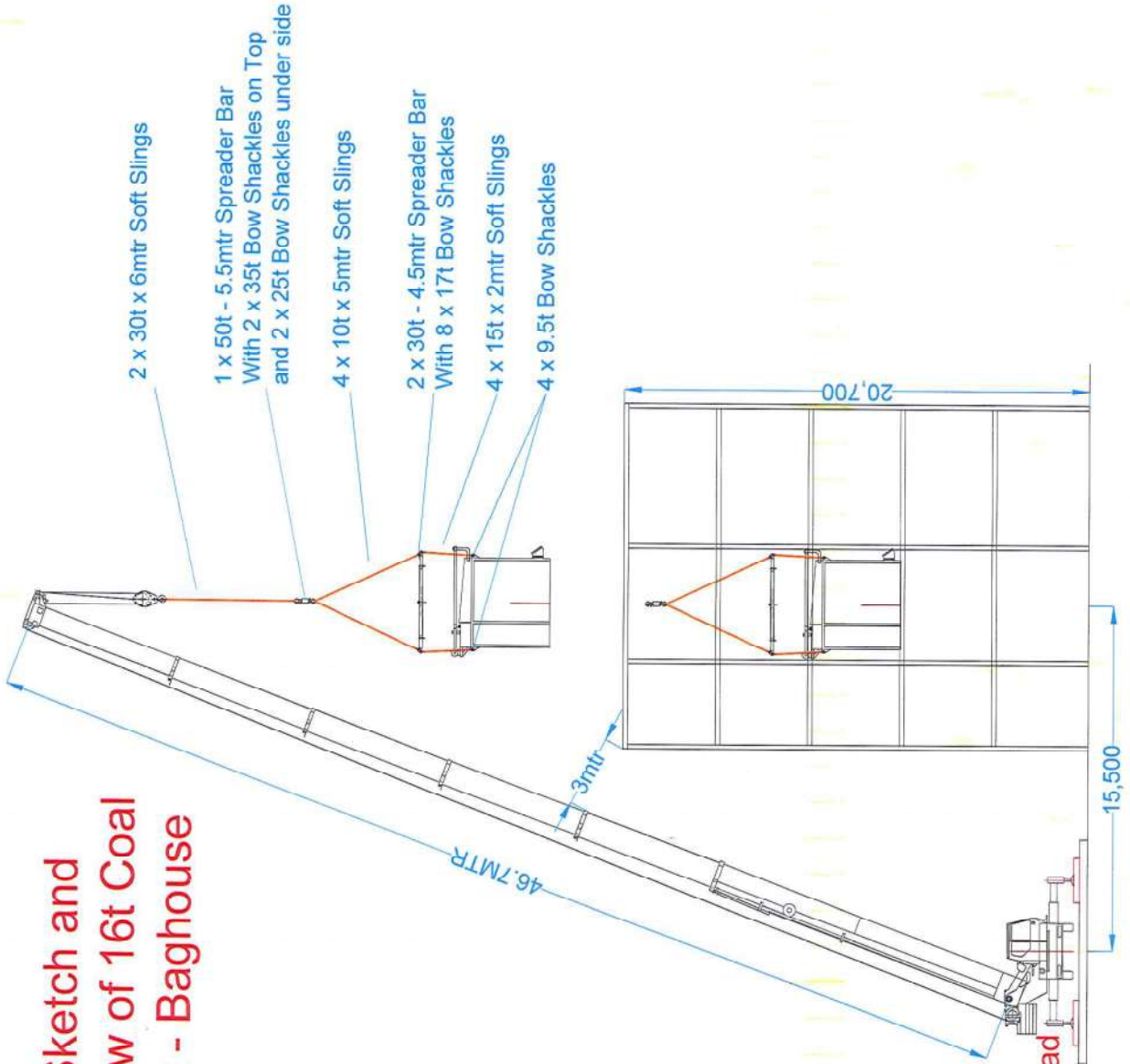

**Tackle Calculations**

Description	Quantity	Weight Each	Total Weight
50t x 6m Spreader Bar	1	500kg	500kg
30t x 6mtr Soft Slings	2	36.9kg	73.8kg
35t Bow Shackles	2	18.15kg	36.30kg
25t Bow Shackles	2	12.84kg	25.68kg
10t x 5m Soft Sling	4	9.07kg	36.28kg
30t x 6m Spreader Bar	2	260kg	520kg
17t Bow Shackles	8	7.43kg	59.44kg
15t x 2m Soft Slings	4	6.8kg	27.20kg
9.5t Bow Shackles	4	3.16kg	12.64kg
<b>Total Weight - KG'S</b>			<b>1,291.34</b>

All Equipment is supplied in accordance with MAX Cranes & Equipment Hire Terms & Conditions & Relevant Australian Standards. This drawing and the technical information it covers must not be copied, used or altered, without the permission of Max Cranes & Equipment Hire (53) Pty Ltd

**MAX**  
SPECIALIST LIFTING  
EQUIPMENT HIRE  
TRANSPORT

Head Office: Tel: 0886413955 Fax: 0886413977  
130 Fifth Street, Uffington, NSW 2885  
Internet: www.maxcranes.com.au

Client: PPRCMT  
Site: NYRSTAR-PORT-PIRE  
Project: NYRSTAR-TRANSFORMATION-PROJECT  
Title: COAL-GRINDING-FABRIC-FILTER BAGHOUSE-TACKLE-VIEW-SIDE-VIEW

A1 Scale: DNS A1 Scale: DNS  
Date: 19/08/2016 Drawn: N.RUDKIN  
Sheet No: SH12 of SH12 Checked: N.KUPIN  
Drawing No: NYRSTAR0014 Rev: A